

CONDENSADOR TRIAC 0,8 - 160F
 CONDENSADOR RT 1,2 - 20UF

RT

★ PARTI COMUNI
 SERIE "20" X

Recorri Curva da
 84052100
 SIN TORZA 84051600

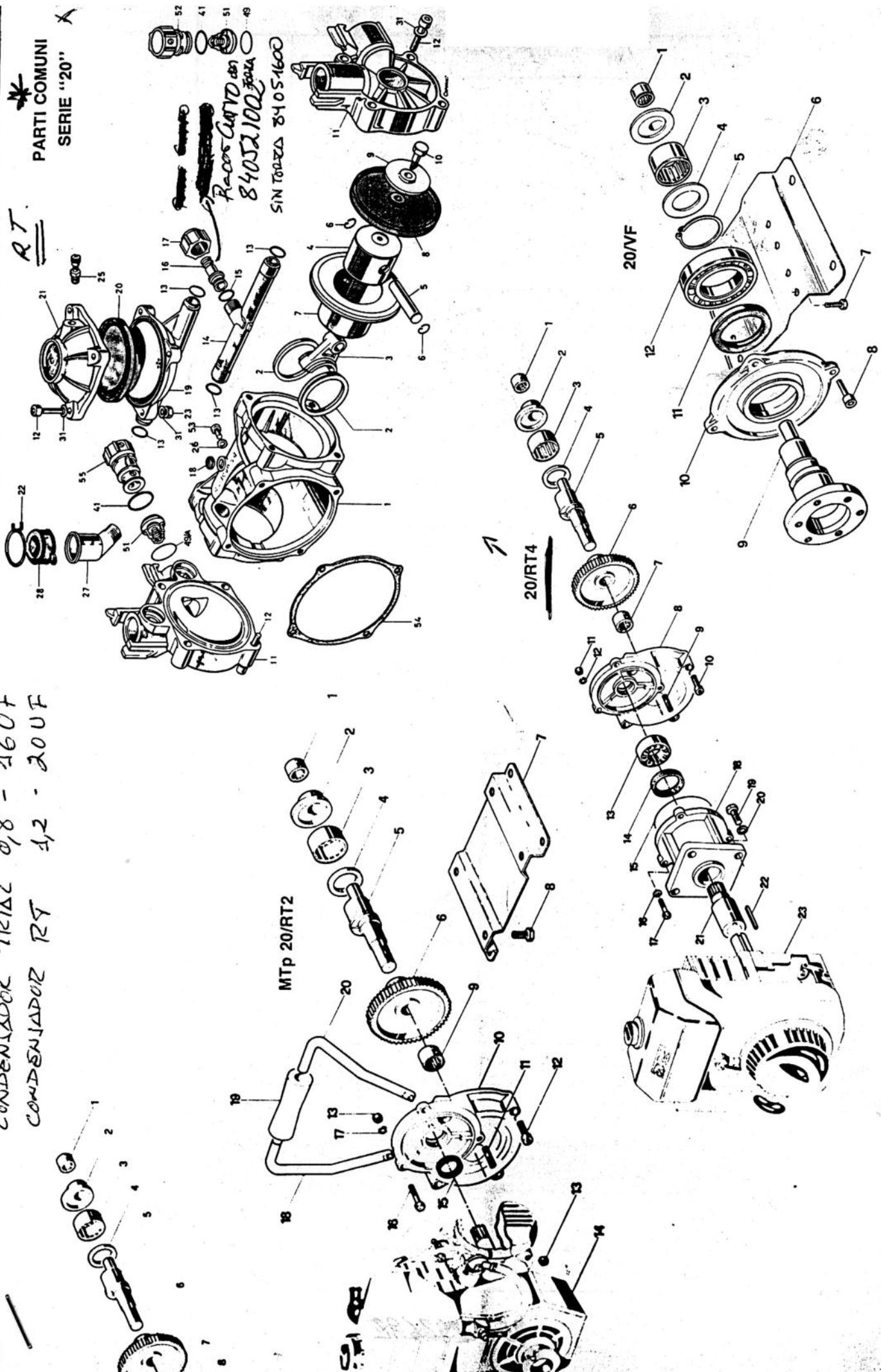



Power in 2 a' diavol. F1705A

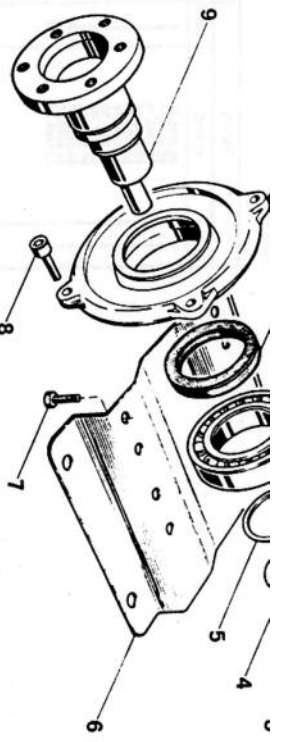

PARTI COMUNI			ELP 20/RT2			MTP 20/RT2			20/RT4			20/VF		
Pos.	Codice	Nr.	Pos.	Codice	Nr.	Pos.	Codice	Nr.	Pos.	Codice	Nr.	Pos.	Codice	Nr.
1	94.0001,09	1												
2	94.0047,76	1												
3	94.0005,09	2												
4	94.0017,08	2												
5	94.0016,08	2												
6	85.2004,00	2												
7	85.2006,00 - 25 VF -	2												
8	80.0003,00	2												
9	80.0007,01	2												
10	94.0015,01 - 25 VF -	2												
11	94.0007,01	2												
12	94.0040,31	2												
13	94.0036,32	2												
14	94.0002,09	2												
15	94.0048,43	2												
16	94.0140,09	2												
17	86.2796,00	2												
18	80.3181,00	4												
19	94.0014,32	4												
20	80.3098,00	1												
21	84.1582,00	1												
22	82.0044,00	1												
23	94.0073,68	1												
24	94.0004,09	1												
25	94.0021,09	1												
26	94.0041,31	1												
27	94.0003,09	1												
28	94.0143,09	1												
29	81.7537,00	1												
30	81.4574,00	1												
31	86.1605,00	1												
32	84.3642,90	1												
33	94.0043,32	1												
34	94.0044,31	1												
35	84.3685,00	1												
36	80.3219,00	1												
37	82.4154,00	1												
38	80.3076,00	1												
39	94.9826,07	1												
40	94.0091,86	1												
41	86.2436,00	1												
42	94.0090,72	1												
43	94.0090,98	1												
44														
45														
46														
47														
48														
49														
50														
51														
52														
53														
54														
55														

Pos.	Codice	N.	Denominazione	KIT
Part. No.	Part. No.	Pezzi	Denominazione	
Q.ty	Q.ty			

Pos.	Codice	N.	Denominazione	KIT
Part. No.	Part. No.	Pezzi	Denominazione	
Q.ty	Q.ty			

N.P.R. 20

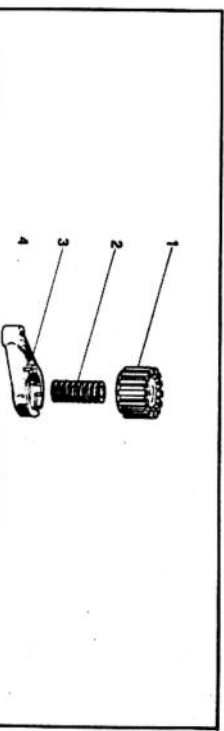

PARTI COMUNI			ELp 20/RTe			MTp 20/RT2			20/RT4			20/VF		
Pos.	Codice	Nr.	Pos.	Codice	Nr.	Pos.	Codice	Nr.	Pos.	Codice	Nr.	Pos.	Codice	Nr.
1	94.0001.09	1	1	81.2531.00	1	1	81.2531.00	1	1	81.2531.00	1	1	81.2531.00	1
2	94.0047.78	1	2	94.0026.32	1	2	94.0026.32	1	2	94.0026.32	1	2	94.0026.32	1
3	94.0005.09	1	3	81.2088.00	1	3	81.2088.00	1	3	81.2088.00	1	3	81.2088.00	1
4	94.0017.08	1	4	94.0027.32	1	4	94.0027.32	1	4	94.0027.32	1	4	94.0027.32	1
5	94.0016.08 - 25 VF	1	5	94.0215.26	1	5	94.0215.26	1	5	94.0215.26	1	5	94.0215.26	1
6	85.2004.00	1	6	94.0212.42	1	6	94.0212.42	1	6	94.0212.42	1	6	94.0212.42	1
7	85.2008.00 - 25 VF	1	7	81.2548.00	1	7	81.2548.00	1	7	81.2548.00	1	7	81.2548.00	1
8	80.0003.00	1	8	86.1935.10	1	8	86.1935.10	1	8	86.1935.10	1	8	86.1935.10	1
9	94.0007.01	1	9	94.0208.09	1	9	94.0208.09	1	9	94.0208.09	1	9	94.0208.09	1
10	94.0015.01 - 25 VF	1	10	86.2281.00	1	10	86.2281.00	1	10	86.2281.00	1	10	86.2281.00	1
11	94.0040.31	1	11	80.2073.00	1	11	80.2073.00	1	11	80.2073.00	1	11	80.2073.00	1
12	94.0036.32	1	12	84.3536.00	1	12	84.3536.00	1	12	84.3536.00	1	12	84.3536.00	1
13	80.3181.00	1	13	81.4525.00	1	13	81.4525.00	1	13	81.4525.00	1	13	81.4525.00	1
14	94.0048.43	1	14	80.3210.84	1	14	80.3210.84	1	14	80.3210.84	1	14	80.3210.84	1
15	94.0002.06	1	15	83.8006.00	1	15	83.8006.00	1	15	83.8006.00	1	15	83.8006.00	1
16	94.0140.09	1	16	31.1324.81	1	16	31.1324.81	1	16	31.1324.81	1	16	31.1324.81	1
17	86.2796.00	1	17	81.4525.00	1	17	81.4525.00	1	17	81.4525.00	1	17	81.4525.00	1
18	80.3181.00	1	18	82.8410.00	1	18	82.8410.00	1	18	82.8410.00	1	18	82.8410.00	1
19	80.3217.00	1	19	86.2303.00	1	19	86.2303.00	1	19	86.2303.00	1	19	86.2303.00	1
20	94.0014.32	1	20	83.2061.00	1	20	83.2061.00	1	20	83.2061.00	1	20	83.2061.00	1
21	80.3098.00	1	21	83.2061.00	1	21	83.2061.00	1	21	83.2061.00	1	21	83.2061.00	1
22	84.1582.00	1	22			22			22			22		
23	82.0044.00	1	23			23			23			23		
24	94.0075.85	1	24			24			24			24		
25	94.0004.06	1	25			25			25			25		
26	94.0021.09	1	26			26			26			26		
27	94.0041.31	1	27			27			27			27		
28	94.0003.09	1	28			28			28			28		
29	94.0143.09	1	29			29			29			29		
30	81.7537.00	1	30			30			30			30		
31	81.4574.00	1	31			31			31			31		
32	86.1825.00	1	32			32			32			32		
33	84.3542.90	1	33			33			33			33		
34	94.0043.32	1	34			34			34			34		
35	94.0044.31	1	35			35			35			35		
36	80.3076.00	1	36			36			36			36		
37	80.3218.00	1	37			37			37			37		
38	82.4154.00	1	38			38			38			38		
39	94.0000.72	1	39			39			39			39		
40	94.9628.97	1	40			40			40			40		
41	94.0091.98	1	41			41			41			41		
42	86.2458.00	1	42			42			42			42		
43	94.0090.72	1	43			43			43			43		
44	94.0090.98	1	44			44			44			44		
45		2	45			45			45			45		

N.P.R. 20

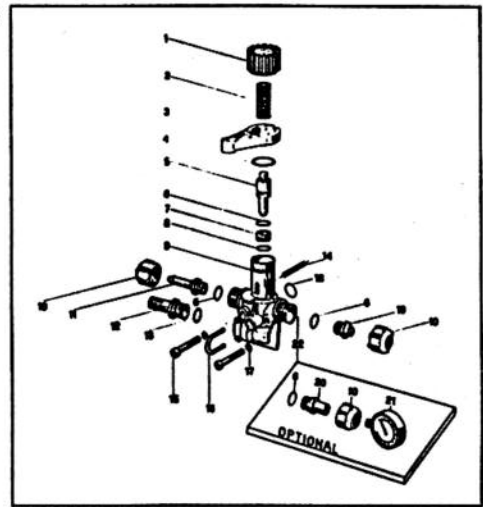

Pos.	Codice Part. No.	N. Pezzi Qty	Denominazione Denomination	KIT
1	94.0203.32	1	Pomello	
2	94.0073.48	1	Molla	
3	94.0202.32	1	Leva	
4	80.3189.00	1	OR 2,62x22	6
5	94.0204.32	1	Ombrello	
6	80.3174.00	3	OR 2,62x8,82	10
7	80.3174.00	1	OR 2,62x8,82 (Gr. manometro)	10
8	05.0068.51	1	Sede valvola	
9	80.3056.00	1	OR 1,78x8,73	10
10	94.0200.32	1	Corpo valvola	
11	82.0015.00	2	Glietto	
12	82.0015.00	1	Glietto (Gr. manometro)	
13	94.1528.00	1	Perlagomma Ø 8	
14	84.1567.00	1	Perlagomma di aspirazione Ø 13	
15	80.3178.00	1	OR 2,62x13,16	10

Pos.	Codice Part. No.	N. Pezzi Qty	Denominazione Denomination	KIT
14	86.1946.00	1	Spina allungata	5
15	86.1943.00	2	Vite T.C.E.L. M6x6	5
16	94.8886.08	1	Balancetta	
17	94.2642.00	2	Roccette D. 6,5	10
18	80.3217.00	1	OR 3 x 14 (Pompa 20/RT)	10
19	80.3086.00	1	OR 2 x 16 (Pompa TRAL)	
20	94.8801.28	1	Tappo	
21	94.8807.32	1	Roccetto attacco manometro	
22	83.8001.00	1	Manometro	
23	94.8846.97	1	Gr. manometro	
24	94.8846.97	1	NPR 20 completo di recordi pompa 20/RT	
25	94.8846.97	1	NPR 20 senza recordi	
26	11.8836.97	1	NPR 20 completo di recordi pompa TRAL	